

# Lampholders for compact fluorescent lamps

26.745

G24 / GX24

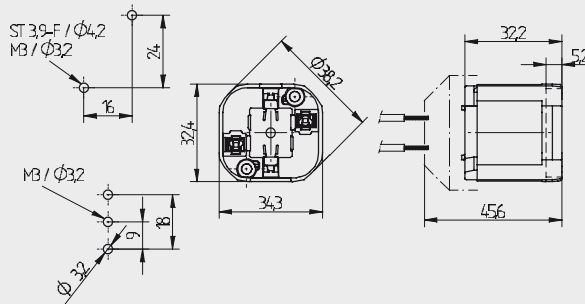

pkg. wt.  
250 14 g

part no.	Key:
<b>26.745.1911.50</b>	d-1 (10 / 13 Watt)
<b>26.745.1921.50</b>	d-2 (18 Watt)
<b>26.745.1931.50</b>	d-3 (26 / 32 Watt)
<b>26.745.1941.50</b>	d (without key)*

For lamps TC-D, TC-T, TC-DEL, TC-TEL

Screw fixing

Snap in fixing

Housing: PBT

Approval: additional cULus (500 V)

- Plain barrel
- Screw fixing vertical, diagonal: two holes  $\varnothing$  3.2 mm
- Panel cut-out: 2 holes, distance 16 / 24, for self-tapping screws ISO 1481 - ST 3.9 - F
- Screw fixing central, vertical: one hole  $\varnothing$  3.2 mm and 2 anti rotation slots
- Panel cut-out: three holes 2 x 9 = 18 mm, for screws ISO 1207 - M3
- Rivet fixing: we recommend blind rivet  $\varnothing$  3.0 mm according to DIN 7337 (Aluminium / Steel flat round head) max. pull force 500 N
- \*Note: Whilst the version of the lampholder without key is designed and constructed to the same high quality standards as the approved versions, there is no valid approval available that we can apply for.

Find accessories on page: [10] 38, [10] 39, [10] 40, [10] 42

