

## Linear Fluorescents: General Applications

26.290.4012

G13 (Medium Bi-Pin): Push-Through Lampholders

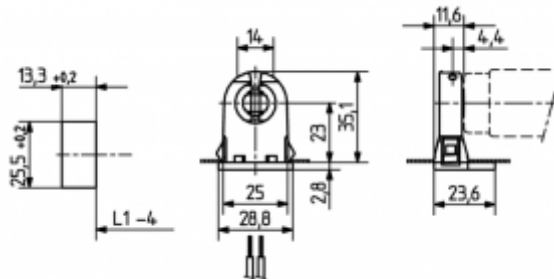

color	pkg.	wt.	part no.
white	500	6 g	26.290.4012.50

Approval: cULus

Lamp center: 23 mm  
Push through mount

Housing: PC  
Rotor: PBT

L1-4: Recommended cutout spacing . "L1" distance is determined by the length of the respective lamp.

- For enclosed cut-outs
- A pair of lampholders provides a lamp length tolerance compensation of 3 mm

T 130	Tm 110	U out 500 V							
							18 AWG 0.5 -1.0 mm²	0.4 - 2.0	